



2500 mAh Power Bank with LED Light

Model no. 035-6152-0

SAFETY INFORMATION

IMPORTANT, RETAIN FOR FUTURE REFERENCE AND READ CAREFULLY!

Read this manual carefully before using the product. Follow all safety instructions to avoid damage caused by improper use. Should this product be transferred to a third person, this manual must be included.

WARNING!

- Make sure your connected device is firmly and securely fastened.
- Follow all applicable local laws and regulations concerning the use of a mobile device.
- The USB port is not designed for transferring data. Do not connect external data storage products or any data transfer cables to the USB port.
- **DANGER!** Never let children play with packaging materials and this product. This product is not a toy! Store the product and any accessories out of the reach of children.
- Don't attempt to disassemble the unit or replace the battery.
- Do not throw device into fire.
- Keep device dry at all time.
- Avoid excessive drops, abrasions and punctures.

| | SPECIFICATIONS |
|------------------|--|
| INPUT | DC 5.0 V/1 A |
| OUTPUT | DC 5.0 V 1 A |
| BATTERY CAPACITY | 2500 mAh/9.25 WH rechargeable Lithium Battery |
| ADAPTABLE FOR | iPod/iPhone/Smartphones/GPS/MP3player/ Bluetooth/other portable devices |
| DIMENSIONS | 111 x 23 x 23 mm/4 3/8 x 7/8 x 7/8" |

PACKAGE CONTENTS:

1. 2500 mAh power bank
2. Charging cable
3. User manual

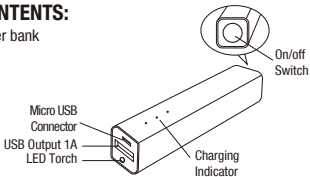

ATTENTION: Press and hold the on/off switch button to turn on or turn off the light.

OPERATION INSTRUCTIONS:

1. Charging the Power Bank

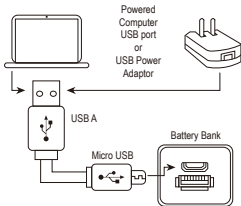

Use provided micro charging cable to charge your battery bank from any 1 A outlet or powered USB port.

Attention: Please recharge the battery pack fully via its cable when using it for the first time.

2. Charging the Electronic Devices

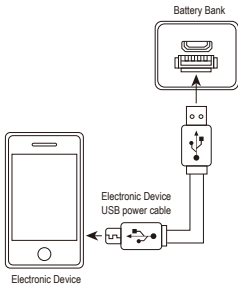

Made in China

Imported by Trileaf Distribution Toronto, Canada M4S 2B8

Product must be recycled or disposed of properly. Dispose of as per the requirements of your local municipality.

